

**HIGH SECURITY ACCESS DOOR
FOR ALL SURFACE TYPES**

PHS

INSTALLATION

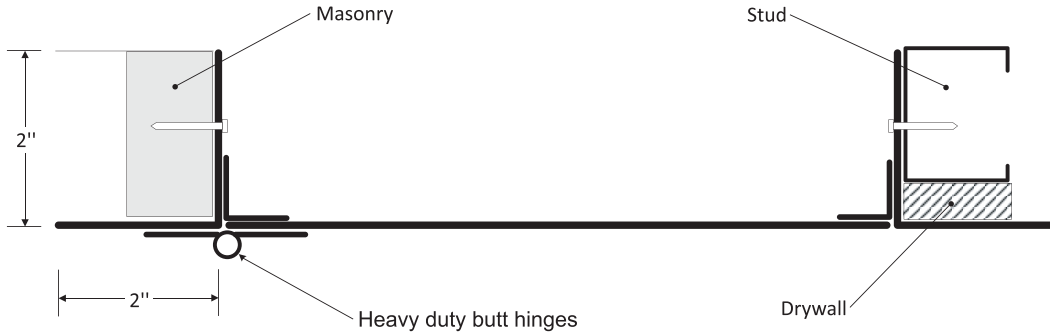

DIMENSIONS AND APPEARANCE

LEED ready: This product contributes to LEED® credits.

DOOR SIZE - W x H INCHES (MM)	WEIGHT LBS KG
12 x 12 (304 x 304)	22 10
16 x 16 (406 x 406)	30 13.6
18 x 18 (457 x 457)	34 15.4
24 x 24 (609 x 609)	49 22.2
24 x 30 (609 x 762)	57 25.9
24 x 36 (609 x 914)	65 29.5
36 x 36 (914 x 914)	86 39
Rough wall opening is door size + 1/4" or + 6mm	

**ACCESS DOORS
MADE FAST!**

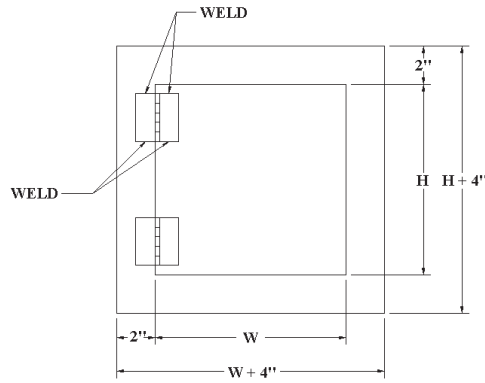

Lock and cylinder optional

DESCRIPTION AND MATERIAL SPECIFICATION

- Material:** 10 gauge cold rolled steel plate
2" x 2" x 3/16" thick angle frame
- Hinge:** 3" x 3" (13 Ga Steel) heavy duty butt hinges
13 gauge cold rolled steel
- Lock / latch:** as per customer's request
- Finish:** high quality white powder coat primer
- Packaging:** individually wrapped, 1 per box

POPULAR OPTIONS:

- Lock / latch:** mortise deadbolt lock (cylinder optional);
mortise preparation for detention lock

PROJECT DATA

PROJECT NAME:	QTY	W	H	OPTIONS
ARCHITECT:				
DEALER:				
CONTRACTOR:				
LOCATION:	SPECIAL INSTRUCTIONS:			
DATE:				
TAGGING INSTRUCTIONS:	SUBMITTAL APPROVAL: (signature or stamp)			