

HOLLOW METAL DOORS

Standard & Custom Engineered Doors & Frames Since 1972

▶ MDI® Typical HM Door Construction: HMD Door Series

- A. Standard doors built with galvanized (A40) steel. G90 and Stainless steel are optional. Available steel gauges: 20, 18, 16, 14.
 - B. Door core: Honeycomb, polystyrene, polyurethane, steel stiffened or temperature rise.
 - C. Standard doors built with 10 gauge high frequency dual purpose hinge reinforcements with return bend for added strength and rigidity. Hinge reinforcements can be easily field converted to accommodate heavy weight hinges.
 - D. 18 gauge inverted top channel projection welded to the door skins and tack weld at each corner for added rigidity. Vinyl cap at top or metal cap at top (flush and water-tight) are optional.
 - E. 18 gauge door closer reinforcement—box style is standard.
 - F. 18 gauge inverted bottom channel projection welded to the door skins and tack weld at each corner for added rigidity. Metal cap at bottom (flush and water-tight) is optional.
- 7 gauge hinge reinforcements are optional.
 - Seamless edges are optional.
 - Custom engineering is available. Contact us for details.

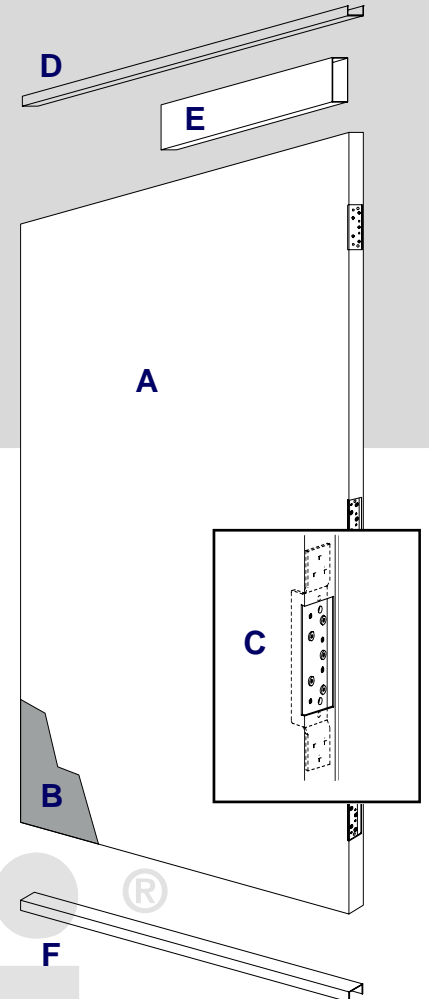

▶ Six Available Door Cores at Metropolitan Door Industries

Contact our customer service department for complete door core offering, details and availability.

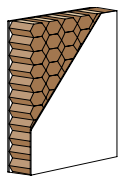

Honeycomb
HMD-HC

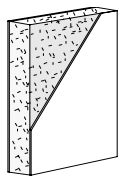

Polystyrene
HMD-PS

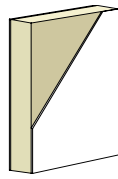

Polyurethane
HMD-PU

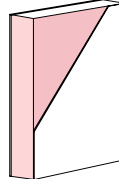

Temp. Rise*
HMD-TR

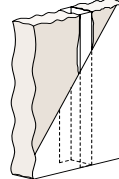

Steel Stiffened
HMD-S
(HC, PS, or PU)

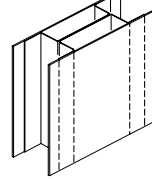

Steel Stiffened
HMD-MED
(High Security)

▶ Standard Lock Preps

161: Cylindrical lock reinforcement with added barrel support, projection welded to the door edge, in accordance with ANSI A115.2 requirements.

86 Edge: Mortise lock prep reinforcement box with incorporated lock support, in accordance with ANSI A115.1 requirements.

PR: Rim panic reinforcement for surface mounted exit device application.

Special lock preparations are available. Preps such as, card-key locks, surface vertical rods, concealed vertical rods and multi-point lock systems to name a few.

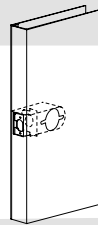

161

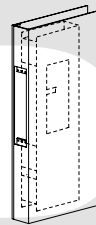

86 Edge

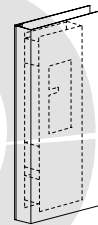

PR

▶ Fire Labeling

Metropolitan fire labeled steel doors are approved by both Intertek Testing Services (ITS/Warnock Hersey) and Underwriters Laboratories (UL) Fire Labeling programs. Fire labeled steel doors must be installed with an equivalent fire labeled frame with approved fire listed hardware. Some restrictions do apply.



516.294.1801 | metropolitandoor.com | Fax: 516.294.1828



HOLLOW METAL FRAMES

Standard & Custom Engineered Doors & Frames Since 1972

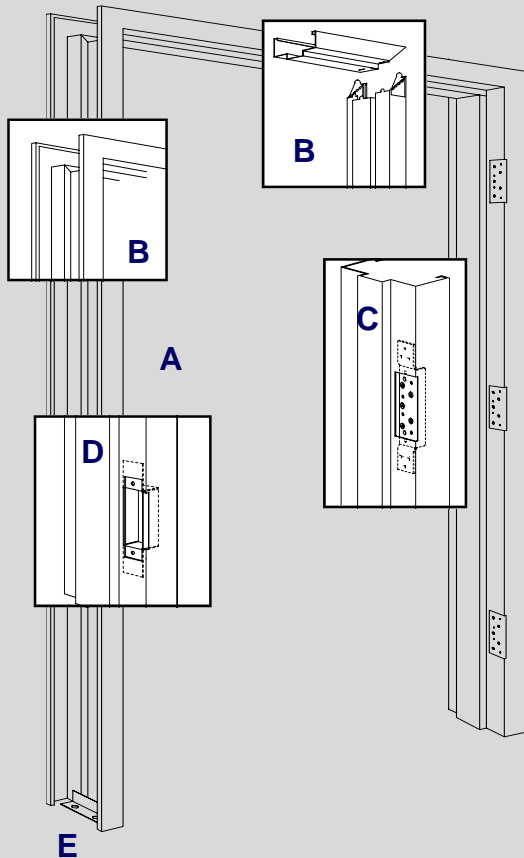

▶ MDI® Typical HM Frame Construction: KD & WF Series Frames

- A. Standard frames are built with 12, 14, 16, 18 or 22 gauge galvanized (A40) steel. G90 and Stainless steel are optional.
 - B. Corner connection: KD (Knock-down) unassembled or WF (welded) assembled. For welded construction MDI® offers two welding options: (1) Face welded (WF-standard); & (2) Fully welded (FWF) - welded from the face through the throat, to the other face.
 - C. 10 gauge high frequency dual purpose hinge reinforcement with return bend for added strength and rigidity. Hinge reinforcements can be easily field converted to accommodate heavy weight hinges.
 - D. 18 gauge ASA strike reinforcement with closed back.
 - E. 18 gauge floor anchor.
- 7 gauge hinge reinforcements—optional.
 - G90 galvanized and stainless steel are optional.
 - Mortar guards standard (except on knock-down).
 - Standard double rabbet profile (unequal rabbet). Equal rabbet and other profiles are available.
 - 1/2" return bends on standard frames. Slip-on Frames (no return bends) and custom engineered frames are available.
 - Drywall return is standard on all stock frames. Custom frames are available.
 - Fire rating: 3/4, 1 1/2, or 3 hours available. Some restrictions do apply.
 - Fire labeling: WHI and UL.
 - Custom engineering is available. Contact us for details.

Frames Types Available:

- Welded
- Knock-down
- Adjustable knock-down
- Standard galvanized
- G90 galvanized
- Stainless steel
- STC (Acoustical)
- Lead-lined (x-ray)
- Bullet resistant
- Blast resistant
- Borrowed-lite windows
- Side-lites & transoms
- Thermally broken
- Slip-On (no return bends)
- Mullions & sticks
- Window wall systems

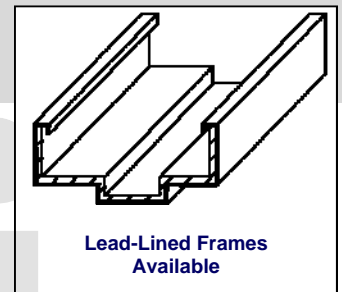
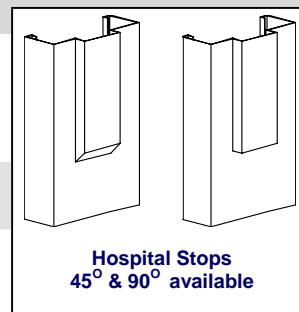

▶ Fire Labeling

Metropolitan fire labeled steel frames are approved by both Intertek Testing Services (ITS/Warnock Hersey) and Underwriters Laboratories (UL) Fire Labeling programs. Fire labeled steel frames must be installed with an equivalent fire labeled door with approved fire listed hardware. Some restrictions do apply.



NOTE: Metropolitan supplies its welded frames with temporary spreaders which are welded to the bottom of each jamb. These spreaders are not to be used for aligning the frame during installation. The sole purpose of the spreaders are to maintain proper alignment during shipment only.

516.294.1801 | metropolitandoor.com | Fax: 516.294.1828

