

## HMD DOOR SERIES OPTIONS

**NOTE:** Door data varies depending on specific design criteria and options chosen.

### DOOR EDGE:

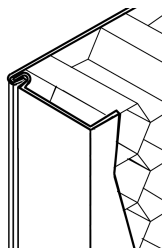

**Lockseam Edge**  
Mechanically interlocked edge seam

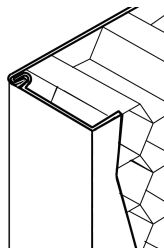

**Seamless Edge**  
Welded every 2-3 inches dressed smooth with Bondo

### END CHANNELS:

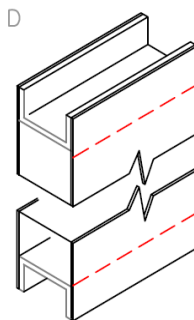

**Inverted End Channels**  
Top & bottom - standard

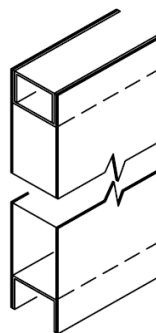

**Steel Top Cap**  
Top, bottom or both. Water-tight capping is also optional

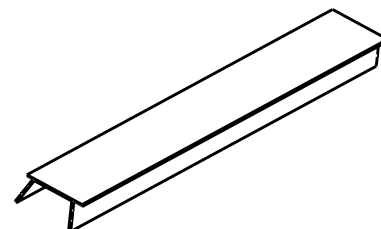

**Extruded Vinyl Cap**  
Top only

### HINGES:

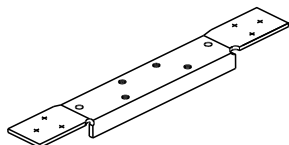

**10 Ga High Frequency Hinge Reinf.**  
Standard weight (.134) hinge reinf w/ return bend

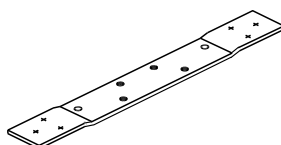

**7 Ga Hinge Reinf.**

- Other hinge options are available. Contact MDI for details.
- Standard hinge reinforcements can accommodate heavy weight (.180) hinges via field modification

### LOCK PREP:



**161**  
Single bore

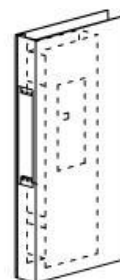

**86E**  
Mortise edge pocket

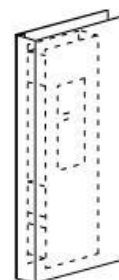

**PR - No C/O**  
Rim panic reinf.

- Other lock options are available. Contact MDI for details.

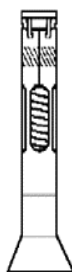

**3/8" Expansion Bolt** (EMA, EMAO, EON Anchor)

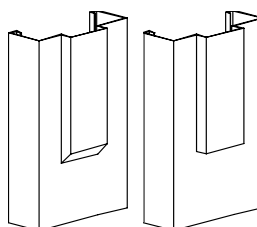

**Hospital Stops**  
45° & 90°

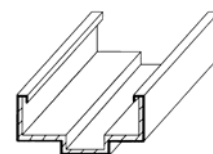

**Lead-Lined Frame**  
Fully Lead-Lined



## HMD DOOR SERIES OPTIONS

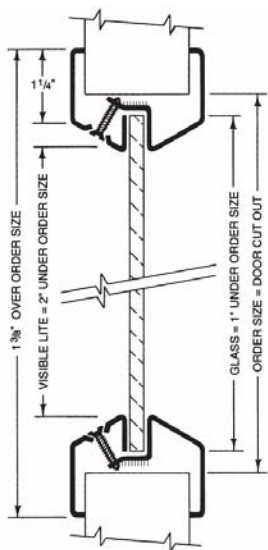

**VLF-EZ**  
Metal Vision Kit

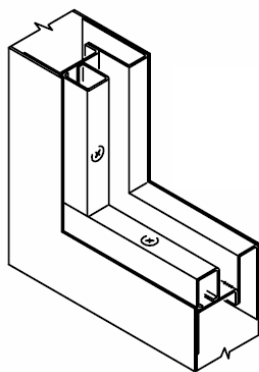

**Flush Molding Vision Kit**  
HMD-MED only (Custom)

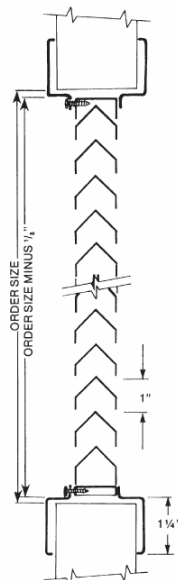

**800-A1**  
Metal Louver Kit

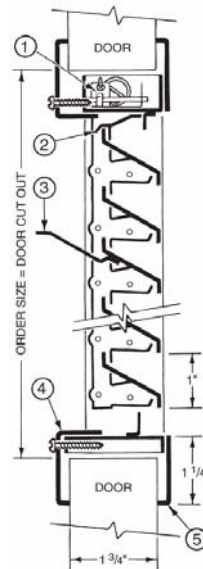

**1900-A**  
Metal Fusible Link  
Louver Kit

**NOTE:**

Other vision kit and louver kit styles are available. Please contact our customer service department for more information.

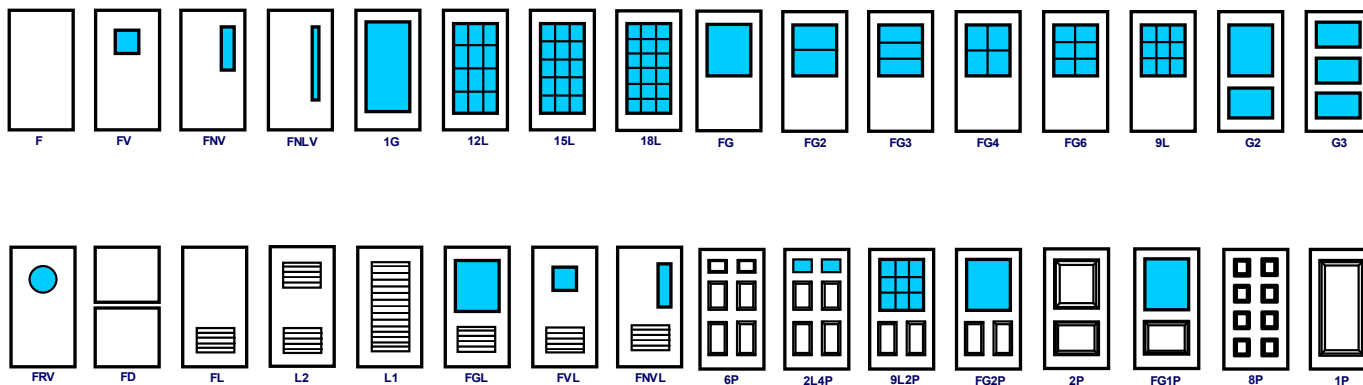

■ Indicates glass vision kit. Glass type and vision kit varies. Some restrictions do apply.

The above door elevations are samples of what can be manufactured. Custom engineered doors and frames are available. Elevations names are for informational purpose only - they can vary from order to order to conform to architect or owner's request.

